

# OCAM

**4X4**  
**ACCESSORIES**

## INSTALLATION INSTRUCTIONS

PART NUMBER: SSE2-DMAX-21

APPLICATION: ISUZU D-MAX / MUX / MAZDA BT50, 08/2021-On

FITTING TIME: 4 hours



OCAM 4x4 Accessories  
31 Shirley Way, Epping, VIC 3076  
Telephone (03) 9357-0306  
Email: [hello@ocam.com.au](mailto:hello@ocam.com.au)  
ABN: 33166112278

## IMPORTANT INFORMATION

- Always wear safety glasses and hearing protection.
- Make sure work area is kept clean at all times.
- Check that all components, as listed, are present.
- Thoroughly read all instructions.
- This product or its fasteners must not be modified in any way.
- These instructions are accurate as at the revision date and do not take into account any changes made by the vehicle manufacturer to vehicle design after the revision date, or other accessories that are or have been fitted to the vehicle.
- It is the responsibility of the installer to confirm correct operation/clearance of all components.
- All holes drilled must have all burrs and swarf removed then coated with a suitable rust preventative paint.
- Ensure that all hardware is fastened to torque list as detailed in these instructions.
- On completion of the job, these instructions are to be given to the customer.

## PRODUCT CARE

- To maintain the appearance of the product, wash and dry regularly using a quality car wash.
- The product should be periodically checked for tightness.

Torque Settings		
BOLT SIZE mm	TORQUE Nm	TORQUE ft.lb
M5	5	4
M6	9	7
M8	22	16
M10	44	32
M12	77	57

## Tools Required

- |  |  |
|--|--|
| <ol style="list-style-type: none"> <li>1. </li> <li>2. </li> <li>3. </li> <li>4. </li> </ol> | <br><br><br> |
|--|--|

# COMPONENTS LIST



ECU



LF / RF idler bracket 2 pcs

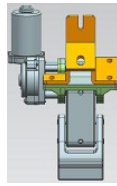

LM motor bracket 1PC



LR / RR idler bracket 2pcs

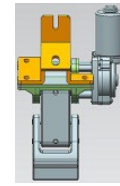

RM motor bracket 1pc



Wire harness: one set for motor power and signal



M8x30 socket cap bolt 8 PCS



M6x25 socket cap bolt 12 PCS



M8 washers 6PCS



M6 spring washer 12PCS



U-shaped washers 10 PCS



M6 washers 12PCS



M8 nut with conical washer 4 PCS



Plastic line 1



OBD Kit 1 Set



Cable ties 20PCS



Side Steps 2PCS

## 1. Install ECU, OBD & Wiring



1. Remove the fuse from the supplied wiring harness

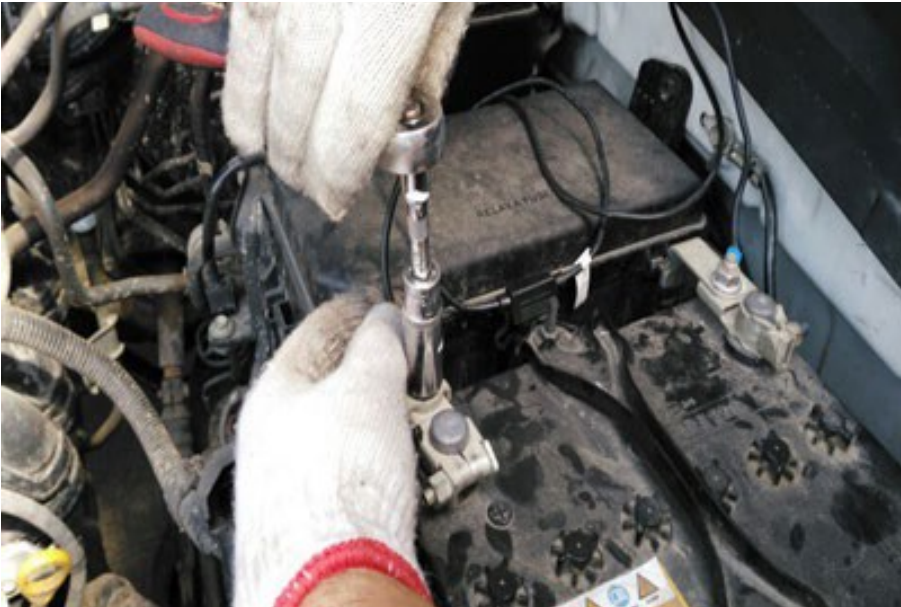

2. Connect the positive wire (red with fuse) to the vehicle battery-positive terminal



3. Connect the negative wire to the vehicle battery-negative terminal. Caution: Ensure nuts are tight.



4. Route the left-hand motor harness along the chassis and through the rubber support block to the passenger side



5. The left hand motor harness as shown above



6. Repeat on the right side with the right motor harness, bringing it to the right side.



7. Using the existing rubber grommet on the firewall as shown, route the harness (three lines) through to the cabin.



8. Inside view of instruction #7.



9. Join the 2 connectors as shown. Cover connectors in electrical and store in the car to ensure it is kept away from water.



10. Secure the ECU module in the left hand side kick-panel



11. The signal for ECU is sourced from each door switch



12. Remove the trim panels behind each door to gain access to the door switch



13. Remove the original connector and insert the supplied adapter harness. Then piggy-back (re-install) the original connector. Do the same for all 4 doors

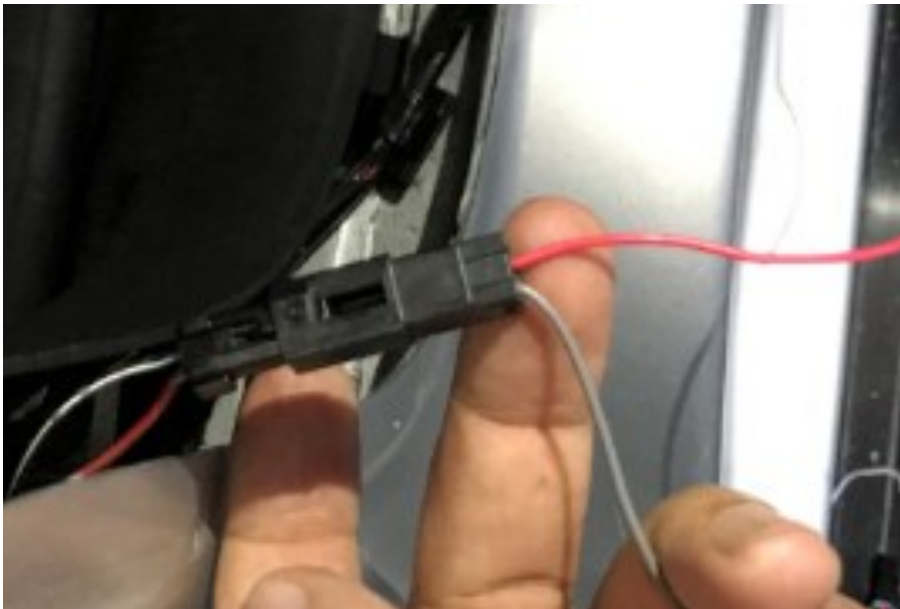

14. Route the door switch wiring harness you have just installed along the original factory harness to the supplied ECU module

15. Connect the motor connectors and use electric tape to secure the connections. Connect all connectors to the ECU module. Insert the fuse and test if the motor works correctly.

## 2. Install connections (left side, 2 sides in same way to install)

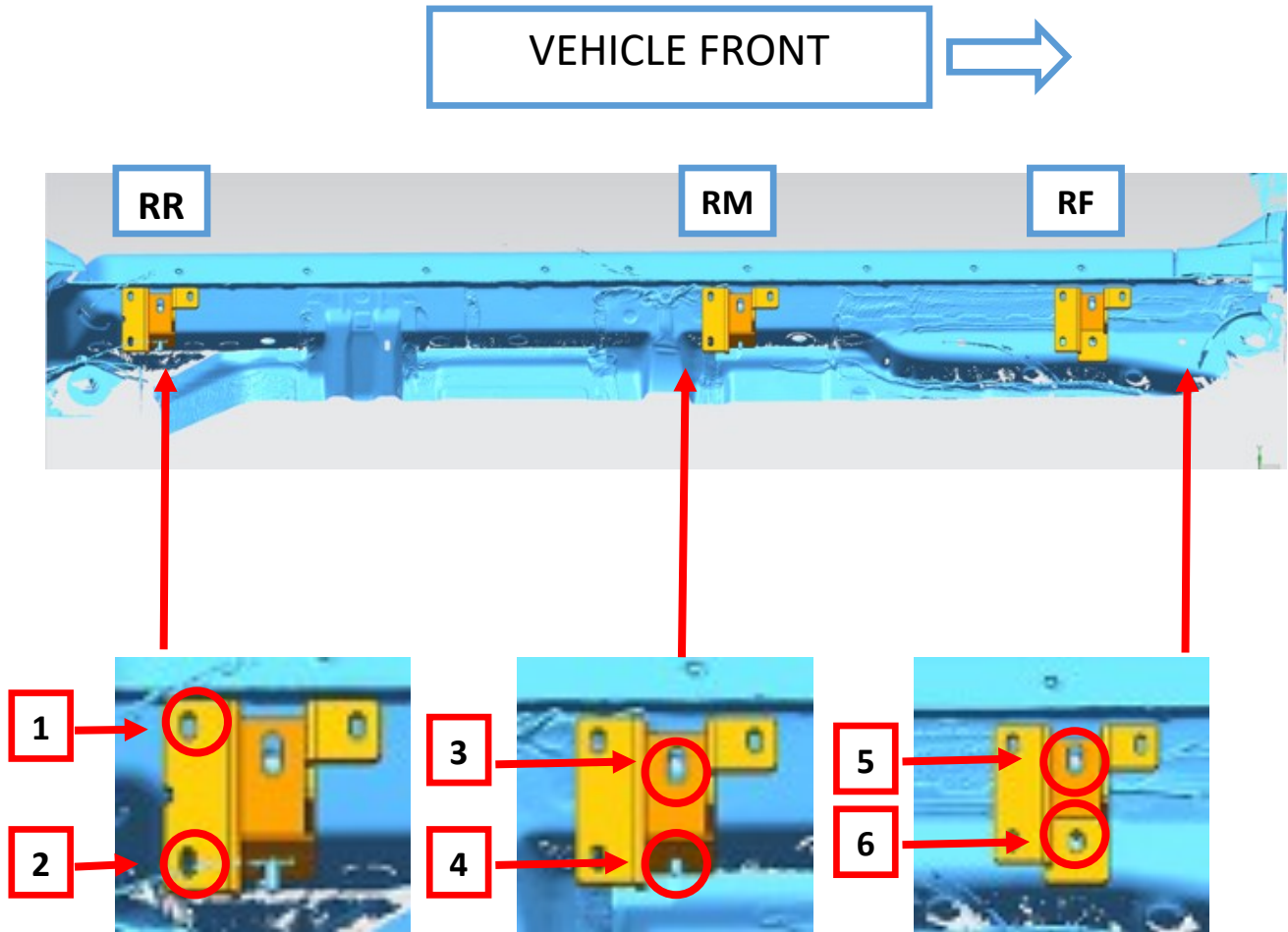

Position 1 and 3 use M8 nuts to fix

Position 2.4.5.6 use M8x30 socket cap bolt to fix RF 5 6

**TIGHTEN ALL BOLTS!**

3. Install the brackets to the left (passenger) side, Then do the same to the right (driver) side.

VEHICLE FRONT 



RR

RM

RF

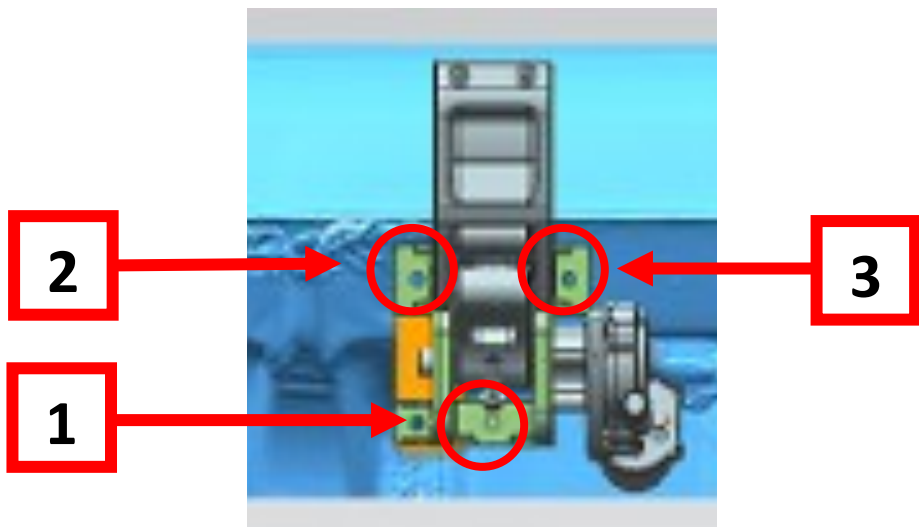

For positions 1, 2, 3, use M8X30 bolts and nuts to fix

All 3 brackets are installed in the same way

**KEEP ALL BRACKET BOLTS SLIGHTLY LOOSE, SO THAT THE BRACKETS CAN BE ADJUSTED WHEN BALANCING THE STEPS**

4. Install the side steps. Left and right are installed in the same way

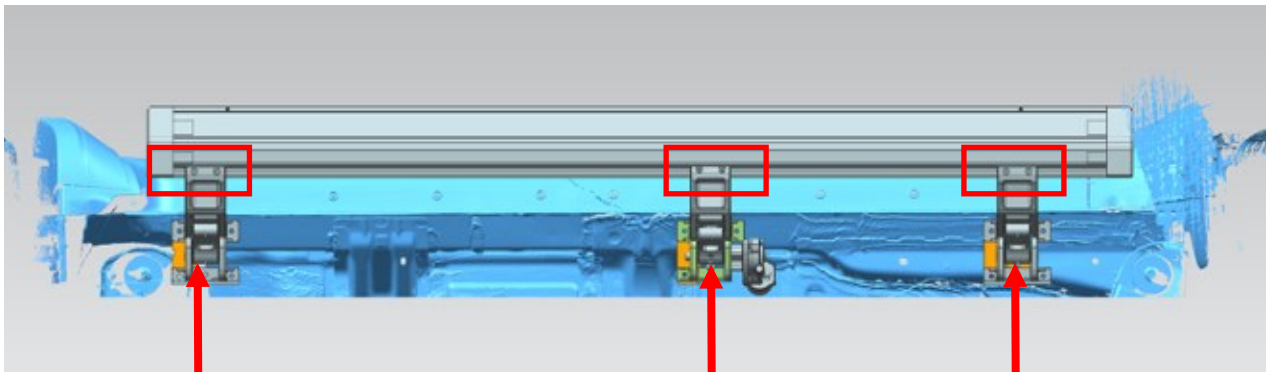

Use M6x25 socket cap bolts with spring washers to fix running boards to the brackets..

**TIGHTEN BOLTS!!**

5. Testing and adjusting side steps balance.

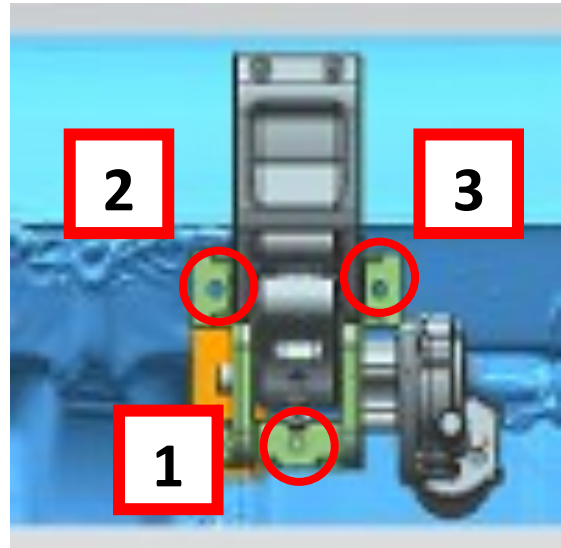

1. Re-insert the fuse into the wiring harness. Then open and close the doors to check that the steps work correctly. Ensure the steps are free of any obstruction. As they move up and down they will adjust to the correct position

2. **TIGHTEN ALL BOLTS ON THE 6 BRACKETS (3X6=18).** If the side steps are out of alignment, use the U-shaped washers to adjust them.

6. Check that the side steps are working correctly upon opening and closing the doors. The installation is now complete. Thank you for choosing the OCAM Electric Side Steps. Enjoy!!





**DEMO: CORRECT HOIST LIFTING**



**TO CHANGE TYRE**

## **Automatic power deployment:**

The side steps will extend down and out when the door is opened.

## **Automatic stop:**

If an object is in the way of the moving side step, the side step will automatically stop. To reset, clear any obstruction, then simply open and close the door to resume normal operation.

## **Manually set in the deployed (OUT) position for access to the roof:**

Stand on the side step while closing the door. To resume normal operation, open and close the door.

## **Maintenance:**

In adverse conditions, debris such as mud, dirt, and salt may become trapped in the side step mechanism, possibly leading to unwanted noise. If this occurs, avoid spraying the motors directly and after washing, apply silicone spray lubricant to the hinge pivot pins.

Caution! Keep hands and feet away when the side steps are in motion.

Thank you for choosing the OCAM Electric Side Steps. Enjoy!!